

| DRAWING | DIMENSIONS | BODY MATERIAL | N° |
|------------|--|---------------------------|----|
| 1BF1-014CP | D 50-T 4-H10.00-X 6-V45-R 0.50-T1=0.854 | COPPER BODY FOR POLYIMIDE | 1 |
| 1BF1-022CP | D 50-T 4-H10.00-X 6-V45-R 0.60-T1=1.024 | COPPER BODY FOR POLYIMIDE | 1 |
| 1BF1-015CP | D 50-T 4-H10.00-X 6-V45-R 0.80-T1=1.366 | COPPER BODY FOR POLYIMIDE | 1 |
| 1BF1-021CP | D 50-T 4-H10.00-X 6-V45-R 1.00-T1=1.707 | COPPER BODY FOR POLYIMIDE | 1 |
| 1BF1-006CP | D 75-T 5-H20.00-X 8-V55-R 0.40-T1=0.73 | COPPER BODY FOR POLYIMIDE | 1 |
| 1BF1-019CP | D 80-T 4-H20.00-X10-V60-R 0.20-T1=0.373 | COPPER BODY FOR POLYIMIDE | 1 |
| 1BF1-048CP | D100-T 6-H20.00-X10-V45-R 0.1-T1=0.171 | COPPER BODY FOR POLYIMIDE | 1 |
| 1BF1-046CP | D100-T 6-H20.00-X13.5-V60-R 1.0-T1=1.866 | COPPER BODY FOR POLYIMIDE | 1 |
| 1BF1-042CP | D100-T10-H20.00-X10-V20-R 0.30-T1=0.403 | COPPER BODY FOR POLYIMIDE | 1 |
| 1BF1-043CP | D100-T10-H20.00-X13.5-V20-R 1.0-T1=1.342 | COPPER BODY FOR POLYIMIDE | 1 |
| 1BF1-044CP | D100-T10-H20.00-X13.5-V30-R 1.0-T1=1.50 | COPPER BODY FOR POLYIMIDE | 1 |
| 1BF1-045CP | D100-T10-H20.00-X13.5-V40-R 1.0-T1=1.643 | COPPER BODY FOR POLYIMIDE | 1 |
| 1BF1-003CP | D100-T10-H20.00-X13.5-V45-R 0.50-T1=0.85 | COPPER BODY FOR POLYIMIDE | 1 |
| 1BF1-047CP | D125-T 6-H20.00-X10-V45-R 0.10-T1=0.171 | COPPER BODY FOR POLYIMIDE | 1 |
| 1BF1-020CP | D125-T 6-H20.00-X10-V55-R 0.50-T1=0.91 | COPPER BODY FOR POLYIMIDE | 1 |
| 1BF1-033CP | D125-T 6-H31.75-X15-V45-R 0.60-T1=1.024 | COPPER BODY FOR POLYIMIDE | 1 |
| 1BF1-030CP | D125-T 6-H31.75-X15-V55-R 0.60-T1=1.091 | COPPER BODY FOR POLYIMIDE | 1 |
| 1BF1-008CP | D125-T 6-H31.75-X15-V55-R 0.65-T1=1.182 | COPPER BODY FOR POLYIMIDE | 1 |
| 1BF1-031CP | D125-T 6-H31.75-X15-V65-R 0.60-T1=1.144 | COPPER BODY FOR POLYIMIDE | 1 |
| 1BF1-032CP | D125-T 8-H31.75-X15-V45-R 1.00-T1=1.707 | COPPER BODY FOR POLYIMIDE | 1 |
| 1BF1-036CP | D125-T 8-H31.75-X15-V45-R 1.50-T1=2.561 | COPPER BODY FOR POLYIMIDE | 1 |
| 1BF1-009CP | D125-T 8-H31.75-X15-V55-R 0.65-T1=1.182 | COPPER BODY FOR POLYIMIDE | 1 |
| 1BF1-011CP | D125-T 8-H31.75-X15-V55-R 1.00-T1=1.819 | COPPER BODY FOR POLYIMIDE | 1 |
| 1BF1-012CP | D125-T 8-H31.75-X15-V65-R 1.30-T1=2.478 | COPPER BODY FOR POLYIMIDE | 1 |
| 1BF1-051CP | D125-T12-H20.00-X15-V20-R 1.00-T1=1.342 | COPPER BODY FOR POLYIMIDE | 1 |
| 1BF1-050CP | D125-T12-H20.00-X15-V40-R 1.00-T1=1.643 | COPPER BODY FOR POLYIMIDE | 1 |
| 1BF1-049CP | D125-T12-H20.00-X15-V50-R 1.00-T1=1.766 | COPPER BODY FOR POLYIMIDE | 1 |
| 1BF1-018CP | D150-T 7-H20.00-X10-V38-R 1.45-T1=2.343 | COPPER BODY FOR POLYIMIDE | 1 |
| 1BF1-038CP | D150-T 7-H20.00-X10-V40-R 1.45-T1=2.382 | COPPER BODY FOR POLYIMIDE | 1 |
| 1BF1-023CP | D150-T 7-H50.80-X10-V39-R 1.45-T1=2.363 | COPPER BODY FOR POLYIMIDE | 1 |
| 1BF1-017CP | D150-T 8-H20.00-X10-V38-R 1.85-T1=2.989 | COPPER BODY FOR POLYIMIDE | 1 |
| 1BF1-040CP | D150-T 8-H20.00-X10-V40-R 1.85-T1=3.039 | COPPER BODY FOR POLYIMIDE | 1 |
| 1BF1-004CP | D150-T 8-H20.00-X10-V60-R 1.80-T1=3.359 | COPPER BODY FOR POLYIMIDE | 1 |
| 1BF1-037CP | D150-T 8-H31.75-X15-V65-R 1.35-T1=2.574 | COPPER BODY FOR POLYIMIDE | 1 |
| 1BF1-024CP | D150-T 8-H50.80-X10-V39-R 1.85-T1=3.014 | COPPER BODY FOR POLYIMIDE | 1 |
| 1BF1-041CP | D150-T10-H20.00-X15-V40-R 2.26-T1=3.713 | COPPER BODY FOR POLYIMIDE | 1 |
| 1BF1-035CP | D150-T10-H31.75-X15-V45-R 1.90-T1=3.244 | COPPER BODY FOR POLYIMIDE | 1 |
| 1BF1-026CP | D150-T10-H50.80-X15-V39-R 2.26-T1=3.682 | COPPER BODY FOR POLYIMIDE | 1 |
| 1BF1-013CP | D150-T12-H20.00-X10-V39-R 6-T1=6 | COPPER BODY FOR POLYIMIDE | 1 |

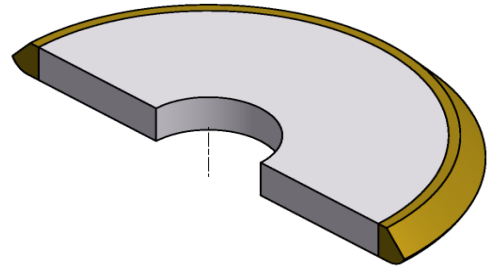
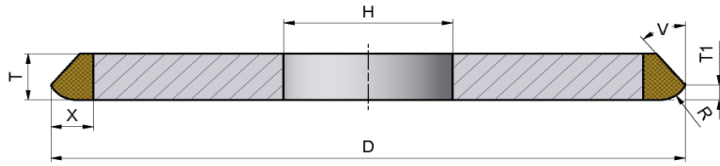

| DRAWING | DIMENSIONS | BODY MATERIAL | N° |
|------------|---|---------------------------|----|
| 1BF1-016CP | D150-T12-H20.00-X15-V20-R 2-T1=3.231 | COPPER BODY FOR POLYIMIDE | 1 |
| 1BF1-039CP | D150-T12-H20.00-X15-V40-R 2.92-T1=4.797 | COPPER BODY FOR POLYIMIDE | 1 |
| 1BF1-001CP | D150-T12-H40.00-X10-V40-R 6.60-T1=3.85 | COPPER BODY FOR POLYIMIDE | 1 |
| 1BF1-010CP | D150-T12-H50.80-X15-V38-R 2-T1=3.231 | COPPER BODY FOR POLYIMIDE | 1 |
| 1BF1-025CP | D150-T12-H50.80-X15-V39-R 2.92-T1=4.758 | COPPER BODY FOR POLYIMIDE | 1 |
| 1BF1-027CP | D150-T13-H50.80-X15-V39-R 3.30-T1=5.377 | COPPER BODY FOR POLYIMIDE | 1 |
| 1BF1-034CP | D150-T14-H20.00-X10-V20-R 4.00-T1=4 | COPPER BODY FOR POLYIMIDE | 1 |
| 1BF1-002CP | D150-T14-H40.00-X10-V40-R 7.80-T1=4.55 | COPPER BODY FOR POLYIMIDE | 1 |
| 1BF1-005CP | D150-T15-H20.00-X10-V20-R 0.30-T1=0.4 | COPPER BODY FOR POLYIMIDE | 1 |
| 1BF1-028CP | D150-T15-H50.80-X15-V39-R 3.81-T1=6.208 | COPPER BODY FOR POLYIMIDE | 1 |
| 1BF1-007CP | D150-T16-H20.00-X10-V15-R 0.30-T1=0.38 | COPPER BODY FOR POLYIMIDE | 1 |
| 1BF1-029CP | D150-T16-H50.80-X15-V39-R 4.32-T1=7.039 | COPPER BODY FOR POLYIMIDE | 1 |