

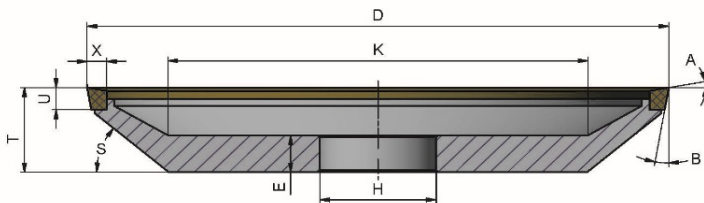

shape N°1

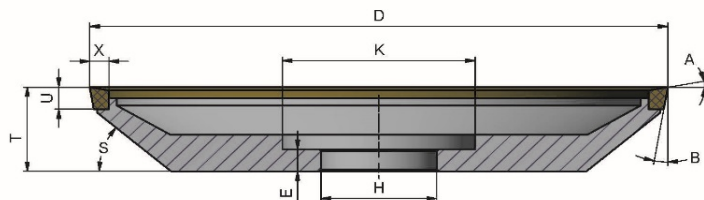

shape N°2



DRAWING	DIMENSIONS	BODY MATERIAL	N°
12BT9-003AP	D125-T23-H31.75-U 3-X 6-E12-K 62-A 3-B25	ALUMINIUM BODY FOR POLYMIDE	2
12BT9-003AR	D125-T23-H31.75-U 3-X 6-E12-K 62-A 3-B25	ALUMINIUM BODY FOR RESIN	2
12BT9-001AP	D125-T24-H31.75-U 3-X 6-E12-K 62-A 4-B10	ALUMINIUM BODY FOR POLYMIDE	2
12BT9-001AR	D125-T24-H31.75-U 3-X 6-E12-K 62-A 4-B10	ALUMINIUM BODY FOR RESIN	2
12BT9-026AR	D125-T26-H31.75-U 6-X 6-E12-K 62-A 4-B10	ALUMINIUM BODY FOR RESIN	2
12BT9-048SM	D150-T15-H32.00-U 4-X 6-A 4-B10-E10-K 85-S45-U1=1	STEEL BODY FOR METAL BOND	1
12BT9-019AP	D150-T22.2-H31.75-U 1-X 6-E12-K 62-A 0-B 0	ALUMINIUM BODY FOR POLYMIDE	2
12BT9-020AP	D150-T22.2-H31.75-U 2-X 6-E12-K 62-A 0-B 0	ALUMINIUM BODY FOR POLYMIDE	2
12BT9-013AP	D150-T23-H31.75-U 1.7-X10-E12-K 62-A 3-B10	ALUMINIUM BODY FOR POLYMIDE	2
12BT9-014AP	D150-T23-H31.75-U 1.8-X10-E12-K 62-A 0-B 0	ALUMINIUM BODY FOR POLYMIDE	2
12BT9-007AP	D150-T23-H31.75-U 2-X 6-E12-K 62-A 0-B10	ALUMINIUM BODY FOR POLYMIDE	2
12BT9-012AP	D150-T23-H31.75-U 2-X 6-E12-K 62-A 0-B47	ALUMINIUM BODY FOR POLYMIDE	2
12BT9-046AP	D150-T23-H31.75-U 2-X10-E12-K 62-A 3-B10	ALUMINIUM BODY FOR POLYMIDE	2
12BT9-046AR	D150-T23-H31.75-U 2-X10-E12-K 62-A 3-B10	ALUMINIUM BODY FOR RESIN	2
12BT9-022AP	D150-T23-H31.75-U 3-X 6-E12-K 62-A 0-B25	ALUMINIUM BODY FOR POLYMIDE	2
12BT9-049AP	D150-T23-H31.75-U 3-X 6-E12-K 62-A 1-B10-U1=0.5	ALUMINIUM BODY FOR POLYMIDE	2
12BT9-023AP	D150-T23-H31.75-U 3-X 6-E12-K 62-A 3-B10	ALUMINIUM BODY FOR POLYMIDE	2
12BT9-033AP	D150-T23-H31.75-U 3-X 6-E12-K 62-A 3-B25	ALUMINIUM BODY FOR POLYMIDE	2
12BT9-033AR	D150-T23-H31.75-U 3-X 6-E12-K 62-A 3-B25	ALUMINIUM BODY FOR RESIN	2
12BT9-025AP	D150-T23-H31.75-U 3-X 6-E12-K 62-A 3-B35	ALUMINIUM BODY FOR POLYMIDE	2
12BT9-047AP	D150-T23-H31.75-U 3-X 6-E12-K 62-A 3-B45	ALUMINIUM BODY FOR POLYMIDE	2
12BT9-047AR	D150-T23-H31.75-U 3-X 6-E12-K 62-A 3-B45	ALUMINIUM BODY FOR RESIN	2
12BT9-009AP	D150-T23-H31.75-U 3-X 6-E12-K 62-A 4-B20	ALUMINIUM BODY FOR POLYMIDE	2
12BT9-006AP	D150-T23-H31.75-U 3-X 8-E12-K 62-A 4-B15	ALUMINIUM BODY FOR POLYMIDE	2
12BT9-044AP	D150-T23-H31.75-U 4-X 6-E12-K 62-A 2-B25	ALUMINIUM BODY FOR POLYMIDE	2
12BT9-011AR	D150-T23-H40.00-U 3-X 6-E12-K 72-A 3-B25	ALUMINIUM BODY FOR RESIN	2
12BT9-055AM	D150-T24-H20.00-U 3-X 6-E12-K 62-A 1-B 0	ALUMINIUM BODY FOR METAL BOND	2
12BT9-021AP	D150-T24-H20.00-U 3-X 6-E12-K 62-A 4-B10	ALUMINIUM BODY FOR POLYMIDE	2
12BT9-038AM	D150-T24-H31.75-U 3-X 6-E12-K 62-A 1-B 0	ALUMINIUM BODY FOR METAL BOND	2
12BT9-038AP	D150-T24-H31.75-U 3-X 6-E12-K 62-A 1-B 0	ALUMINIUM BODY FOR POLYMIDE	2
12BT9-029AM	D150-T24-H31.75-U 3-X 6-E12-K 62-A 4-B10	ALUMINIUM BODY FOR METAL BOND	2
12BT9-029AP	D150-T24-H31.75-U 3-X 6-E12-K 62-A 4-B10	ALUMINIUM BODY FOR POLYMIDE	2
12BT9-029AR	D150-T24-H31.75-U 3-X 6-E12-K 62-A 4-B10	ALUMINIUM BODY FOR RESIN	2
12BT9-051AP	D150-T24-H31.75-U 3-X 6-E12-K 62-A 4-B10-U1=0.5	ALUMINIUM BODY FOR POLYMIDE	2
12BT9-054AP	D150-T24-H31.75-U 3-X 8-E12-K 62-A 0-B10	ALUMINIUM BODY FOR POLYMIDE	2



shape N°1

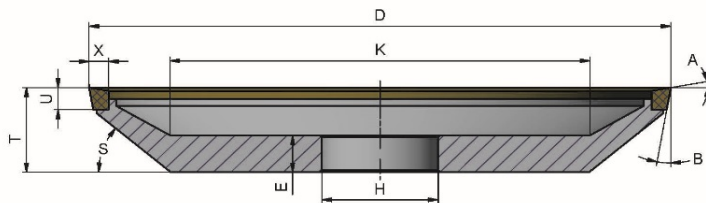

shape N°2

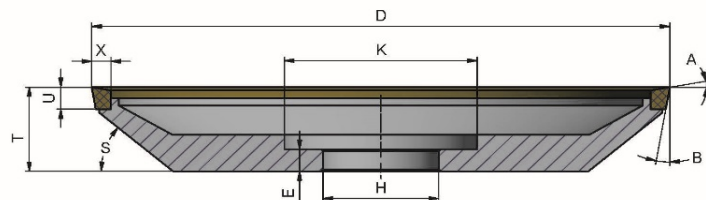

DRAWING	DIMENSIONS	BODY MATERIAL	N°
12BT9-031AP	D150-T24-H31.75-U 3-X10-E12-K 62-A 1-B 0	ALUMINIUM BODY FOR POLYMIDE	2
12BT9-005AP	D150-T24-H31.75-U 3-X10-E12-K 62-A 4-B10	ALUMINIUM BODY FOR POLYMIDE	2
12BT9-005AR	D150-T24-H31.75-U 3-X10-E12-K 62-A 4-B10	ALUMINIUM BODY FOR RESIN	2
12BT9-010AP	D150-T24-H31.75-U 4-X 6-E12-K 62-A 4-B10	ALUMINIUM BODY FOR POLYMIDE	2
12BT9-018AP	D150-T24-H31.75-U 4-X 8-E12-K 62-A 1-B10	ALUMINIUM BODY FOR POLYMIDE	2
12BT9-045AP	D150-T24-H31.75-U 4-X10-E12-K 62-A 1-B 0	ALUMINIUM BODY FOR POLYMIDE	2
12BT9-053AM	D150-T24-H31.75-U4-X 6-E12-K 62-A 3-B10	ALUMINIUM BODY FOR METAL BOND	2
12BT9-040AR	D150-T24-H40.00-U 3-X 6-E12-K 82-A 4-B10	ALUMINIUM BODY FOR RESIN	2
12BT9-050AP	D150-T25-H31.75-U 5-X 6-E12-K 62-A 4-B10	ALUMINIUM BODY FOR POLYMIDE	2
12BT9-050AM	D150-T25-H31.75-U 5-X 6-E12-K 62-A 4-B10	ALUMINIUM BODY FOR METAL BOND	2
12BT9-043AP	D150-T26-H31.75-U 5-X10-E12-K 62-A 4-B10	ALUMINIUM BODY FOR POLYMIDE	2
12BT9-030AM	D175-T24-H31.75-U 3-X 6-E12-K 62-A 4-B10	ALUMINIUM BODY FOR METAL BOND	2
12BT9-030AP	D175-T24-H31.75-U 3-X 6-E12-K 62-A 4-B10	ALUMINIUM BODY FOR POLYMIDE	2
12BT9-041AP	D175-T24-H50.00-U 3-X 6-E12-K 82-A 0-B 0	ALUMINIUM BODY FOR POLYMIDE	2
12BT9-042AM	D175-T24-H50.00-U 3-X 6-E12-K 82-A 3-B45	ALUMINIUM BODY FOR METAL BOND	2
12BT9-039AP	D175-T24-H50.00-U 3-X 6-E12-K 82-A 4-B10	ALUMINIUM BODY FOR POLYMIDE	2
12BT9-032AR	D200-T23-H31.75-U 3-X 4.5-E12-K 62-A 3-B25	ALUMINIUM BODY FOR RESIN	2
12BT9-037AP	D200-T23-H31.75-U 3-X 6-E12-K 62-(special)	ALUMINIUM BODY FOR POLYMIDE	2
12BT9-027AM	D200-T23-H31.75-U 3-X 6-E12-K 62-A 2-B50	ALUMINIUM BODY FOR METAL BOND	2
12BT9-034AP	D200-T24-H31.75-U 3-X 6-E12-K 62-A 3-B28	ALUMINIUM BODY FOR POLYMIDE	2
12BT9-034AR	D200-T24-H31.75-U 3-X 6-E12-K 62-A 3-B28	ALUMINIUM BODY FOR RESIN	2
12BT9-008AP	D200-T24-H31.75-U 3-X 6-E12-K 62-A 4-B10	ALUMINIUM BODY FOR POLYMIDE	2
12BT9-035AP	D200-T24-H31.75-U 3-X 6-E12-K 62-A 4-B18	ALUMINIUM BODY FOR POLYMIDE	2
12BT9-035AR	D200-T24-H31.75-U 3-X 6-E12-K 62-A 4-B18	ALUMINIUM BODY FOR RESIN	2
12BT9-052AM	D200-T25-H20.00-U 5-X 6-E15-K140-A 4-B10	ALUMINIUM BODY FOR METAL BOND	2
12BT9-002AR	D200-T25-H31.75-U 5-X 4.5-E12-K 62-A 4-B18	ALUMINIUM BODY FOR RESIN	2
12BT9-004AM	D200-T25-H31.75-U 5-X 6-E12-K 62-A 4-B18	ALUMINIUM BODY FOR METAL BOND	2
12BT9-004AP	D200-T25-H31.75-U 5-X 6-E12-K 62-A 4-B18	ALUMINIUM BODY FOR POLYMIDE	2
12BT9-004AR	D200-T25-H31.75-U 5-X 6-E12-K 62-A 4-B18	ALUMINIUM BODY FOR RESIN	2
12BT9-024AR	D200-T25-H31.75-U 5-X10-E12-K 62-A 4-B18	ALUMINIUM BODY FOR RESIN	2
12BT9-028AR	D200-T26-H31.75-U 6-X 4.5-E12-K 62-A 4-B18	ALUMINIUM BODY FOR RESIN	2
12BT9-036AP	D200-T26-H31.75-U 6-X 6-E12-K 62-A 4-B18	ALUMINIUM BODY FOR POLYMIDE	2
12BT9-036AR	D200-T26-H31.75-U 6-X 6-E12-K 62-A 4-B18	ALUMINIUM BODY FOR RESIN	2
12BT9-056AP	D250-T25-H31.75-U 6-X 6-E12-K 62-A 3-B15	ALUMINIUM BODY FOR POLYMIDE	2